

## PRE-BID CLARIFICATION FORM

PROJECT NAME:		FILLMORE HIGH SCHOOL NEW ATHLETIC COMPLEX	
PROJECT NUMBER:		Project No. 2024-017 / DSA #03-123950	
TO:		RJ Stump Fillmore Unified School Dist.  Roy Frey WestGroup Designs	
		EMAIL: <a href="mailto:ri.stump@fillmoreusd.org">ri.stump@fillmoreusd.org</a>  <a href="mailto:rovf@westgroupdesigns.com">rovf@westgroupdesigns.com</a>	
DATE:	2/5/2025		
FROM:	Neil Hulin	nhulin@bowecontractors.com	
DOCUMENT/DIVISION NUMBER:	26 51 26	DRAWING NUMBER:	E2-1.2

REQUESTED CLARIFICATION:

Please circle all applicable bid packages below, that this RFI pertains to:

Base bid

Alt #1

Alt #2

Sheet E2-1.2 PLAN NOTES 6 & 8 refer to assisted listening equipment (ALS). Specification section 26 51 26 shows equipment for a multi-purpose room and a conference room, but these rooms don't exist in the floor plans. Please provide the following information so we can price this correctly:

ALS single line, ALS cable schedule, ALS specifications.

PRE-BID CLARIFICATION FORM

RESPONSE TO CLARIFICATION:

See updated Sheets E2-1.2 E601 and E603 for AV Diagram. See added spec 27 36 00 for Autonomous Audio Visual System for Assistive Listening section.  
DL - AGD - 2/10/25

Attach additional numbered sheets as necessary; however, only one (1) request shall be contained on each submitted form.



- PLAN NOTE:
- 1 PROVIDE 24" SQ. X 6" DEEP PULL BOX WITH BARRIERS. PROVIDE PATHWAY BETWEEN BOXES.
  - 2 BLEACHER SEATING AP'S NEED TO BE 6-8FT ABOVE TOP OF SEATING, MOUNTED ON WALL.
  - 3 OUTDOOR AP'S, CAMERAS, AND SPEAKER TO BE STANDARD +BED HEIGHT OF 12'.
  - 4 PROVIDE 12" SQ PULL BOX. DROP DOWN TO SCOREBOARD. 1 1/4" PATHWAY TYP. ABOVE.
  - 5 INDICATES RACKING CONDUIT PATHWAYS ABOVE.
  - 6 PROVIDE AT 12" H.F.F. (2) SQ BOXES WITH:
    - ASS LISTENING
    - WIRE MICROPHONE
    - ANTENNAS
  - 7 PROVIDE 6" SQ LOW VOLTAGE PULL BOX LABEL. AV SYSTEM
  - 8 ANTENNA LOCATION. MOUNTED ON WALL AT 12' AFF. HOMERUN 1 1/4" TO AV ROOM.

- SECURITY INTRUSION.
- KEY PAD.
- EXTERIOR WEATHER PROOF SPEAKER (FLUSH GRILL).
- ATLAS CLOCK/SPEAKER (FLUSH MTD).
- 3/4" UP TO ACCESSIBLE CEILING. (2) - INDICATES CAT 6A CABLE.
- FLUSH W/ FLOOR, DEEP BOX.



19900 MacArthur Boulevard | Suite 1000  
Irvine | California | 92612  
949.250.0880 | FAX 949.250.0882  
www.westgroupdesigns.com

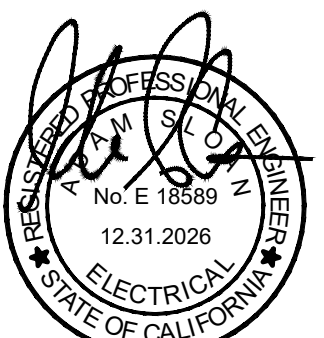

AG Design Inc.  
Consulting Electrical Engineers  
714.769.9900  
www.AGdesignEng.com  
200701 Glenwood Ave Suite 105 | Orange, CA 92668

FILLMORE HIGH SCHOOL ATHLETIC COMPLEX  
FILLMORE UNIFIED SCHOOL DISTRICT  
555 CENTRAL AVE, FILLMORE CA, 93015

ISSUED FOR:

REVISIONS:

REF.1 1-28-25

REGISTRATION/SIGNATURE:

SHEET TITLE:

1ST FLOOR  
LOW VOLTAGE PLAN

SHEET NUMBER:

E2-1.2

WD PROJ. # DRAWN BY: CHECKED: DATE:  
22851 DL, AM GM 06/07/23

© WESTGROUP DESIGNS, INC.

1ST FLOOR LOW VOLTAGE PLAN



1  
1/8" = 1'-0"

NOT FOR CONSTRUCTION







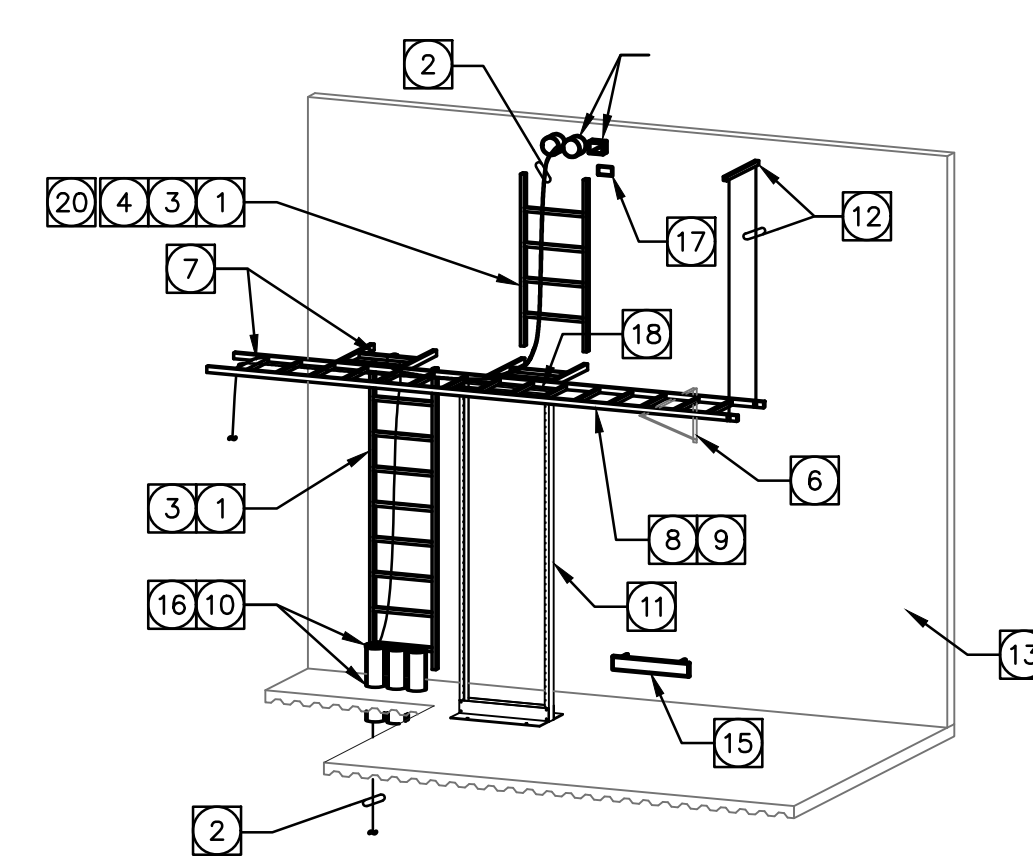
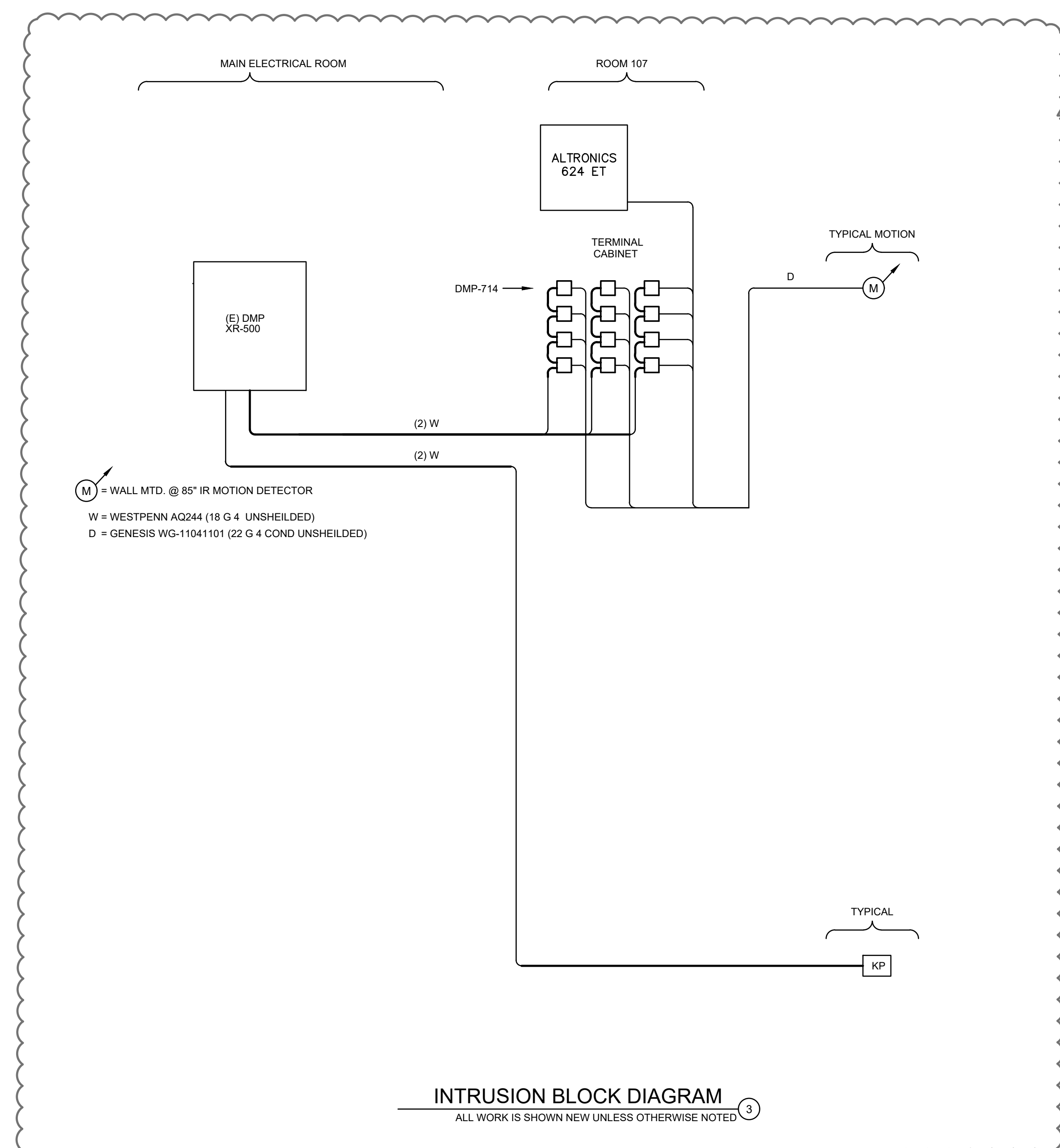

- ## KEYNOTES

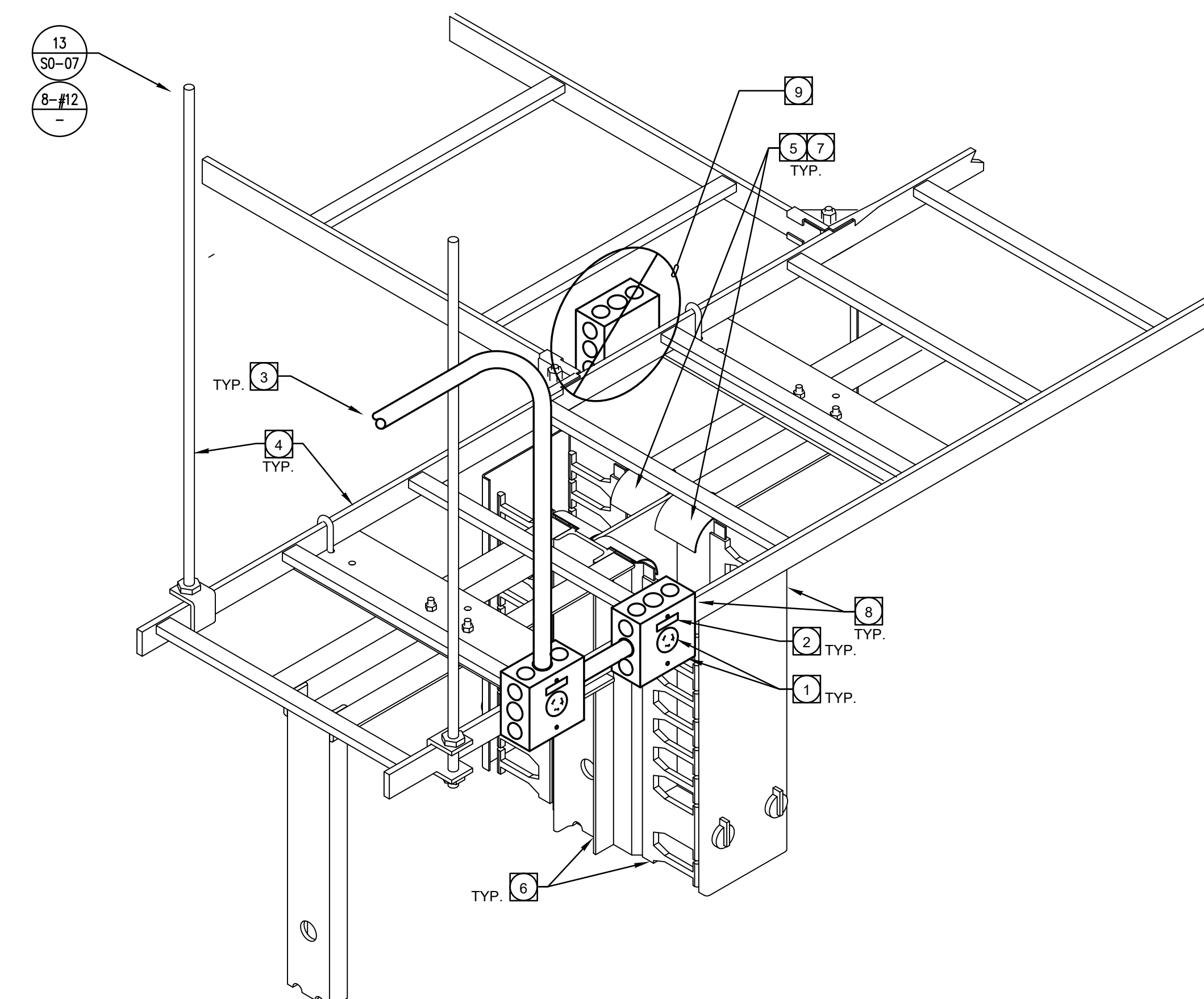
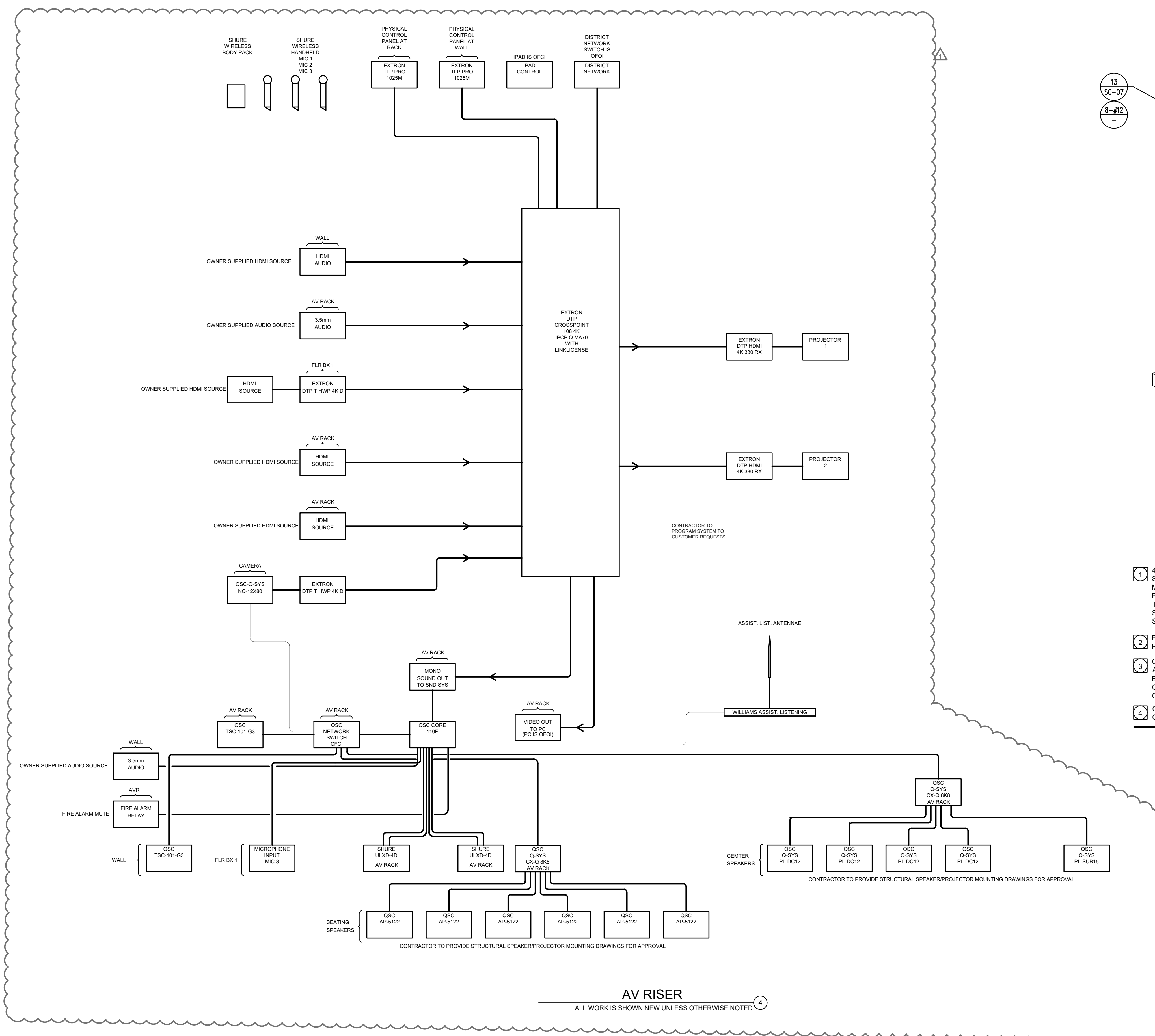

- 4S DEEP NEMA JUNCTION BOX WITH RECEPTACLES PER PLAN ATTACHED SECURELY TO LADDER TRAY. VERIFY CORRECT SIDE OF LADDER TRAY/EXACT MOUNTING LOCATION ON LADDER TRAY WITH OWNER AND SCSS CONTRACTOR PRIOR TO ROUGH-IN. E.C. TO INSTALL JUNCTION BOX ON SIDE OF LADDER TRAY ONLY WITH RECEPTACLE PERPENDICULAR TO FLOOR. JUNCTION BOX SHALL NOT BE INSTALLED ON TOP OR BOTTOM OF LADDER TRAY OR BETWEEN STRINGERS.



2100 W Orangewood Ave Suite 165 | Orange, CA 92865

FILLMORE HIGH  
SCHOOL ATHLETIC  
COMPLEX  
FILLMORE  
UNIFIED SCHOOL  
DISTRICT

555 CENTRAL AVE, FILLMORE  
CA. 93015

ISSUED FOR

REVISIONS:

1	RFI 1	1-29-25
---	-------	---------

REGISTRATION/SIGNATURE

SHEET TITLE

## ELECTRICAL DETAILS

SHEET NUMBER

E603

WD PROJ. #	DRAWN BY:	CHECKED	DATE
22851	DL AM	GM	06/07/23

© WESTGROUP DESIGNS, INC.

## SECTION 27 36 00

### Audio Visual System

#### SECTION 1 – GENERAL

##### 1.01 RELATED DOCUMENTS

A. Drawings and general provisions of Contract, including General and Supplementary Conditions and Division-1 Specifications apply to work of this Section.

##### 1.02 SCOPE OF WORK

A. The work under this section includes all labor, material, equipment, testing, and accessories required to furnish and install a complete, tested, working Audio Visual Projection and Sound System as indicated on the drawings and as specified herein.

B. It is the intent of the Drawings and Specifications for the Contractor to provide and install a complete, fully operational, and tested system.

C. All miscellaneous system components including, but not limited to, cables, termination equipment, punch blocks, patch panels, backboards, dedicated power provisions, as well as any other related items, shall be furnished and installed complete under this section, such that the system shall perform all functions listed herein in compliance with all of the specified requirements.

##### 1.03 GENERAL REQUIREMENTS

A. The contractor shall hold a valid State of California C-7 Low-Voltage and C-10 Electrical License, and shall have completed at least 20 projects of equal scope, shall have been in business of furnishing and installing systems of this scope and magnitude for at least five years, and capable of being bonded to assure the owner of performance and satisfactory service during the guarantee period. Contractor shall be QSC and Extron Certified.

B. The contractor shall hold all other licenses required by the legally constituted authorities having jurisdiction over the work.

C. All work shall be performed under the supervision of a company accredited by the basic equipment manufacturer and such accreditation must be presented. Contractor shall provide training certificates from QSC- Q-SYS Level 1, 2, Control 101, Control 102, Control and UCI Fundamentals, along with Extron Authorized Programmer, Extron Control Specialist, Extron AV Associate, Extron ProDSP Specialist.

D. The installing contractor shall be a factory authorized distributor and warranty station for the brand of equipment offered and shall maintain a fully equipped service organization capable of furnishing adequate repair service to the equipment. The installing contractor shall maintain a spare set of all major parts for the system at all times. All system components shall be 100% backed up with stock at contractors shop.

E. All of the equipment in this specification shall be furnished and installed by the Authorized Factory Distributor of the equipment. The Contractor shall furnish a letter from the manufacturer of all major equipment, which certifies that the installing contractor is the Authorized Distributor and that the equipment has been installed according to factory intended practices.

F. If applicable, all of the equipment in this specification shall be furnished and installed with the most current software package available at the time of installation. At the time of Owner Acceptance of the installation, all equipment shall include any and all updated software revisions. In addition, when the software is available in disk format, a backup copy of the most up to date revision shall be handed to the Owner at the completion of the project.

#### 1.04 QUALITY ASSURANCE

A. In order to maintain a high degree of quality assurance, the contractor shall, without exception, use the parts and supplies as specified in this specification.

#### 1.05 SUBMITTAL AND MANUAL

A. Submittal requirements of this section are:

1. Within thirty-five (35) calendar days after the date of award of the Contract, the Contractor shall submit eight copies of the complete submission to the Architect for review.

2. The submission shall consist of five major sections with each section separated with index tabs. Each page in the submission shall be numbered chronologically and shall be summarized in the index.

3. The first section shall be the "index" which shall include the project title and address, name of the firm submitting the proposal and name of the Architect.

4. The second section shall include a copy of the Contractors valid C-7 and C-10 California State Contractors license and letters from Extron and QSC that the company is a fully licensed distributor of the product specified, a list of 20 projects of equal or greater scope, provide copy of Contractors QSC and Extron Training Certificates as mentioned above, and a list of proposed instrumentation to be used by the contractor. In addition, provide a written notice guarantying the provision of the requested warranty.

5. The third section shall contain the comparative specification listing, including a complete listing of the characteristics of the equipment to be furnished next to all of the specified equipment's features and functions as stated in the specifications and data sheets.

6. The fourth section shall contain an original factory data sheet for every component in the specifications.

7. The fifth section shall contain a designation schedule for each device location and complete 1/8" = 1'-0" scale AutoCAD created drawing showing system wiring plans. Contractor shall also perform EASE analysis and speaker placement calculations and submit. Contractor shall provide structural mounting drawings for Projector and Speakers for review by Structural Engineer. Drawings shall include exact projector mounting location, and conduit

routing and sizing required. The Architect / Engineer will provide AutoCAD format drawings of the original associated plans, upon receipt of a written request from the contractor at no charge.

B. Failure to comply with all of the requirements listed above will result in the rejection of the entire submittal package.

C. The Contractor shall provide two copies of an "Operating and Servicing Manual" for the system. The manuals shall be bound in flexible binders. All data shall be printed material or typewritten. Each manual shall include the following:

1. Instructions necessary for the proper operation and servicing of the system.
2. Complete as-built installation drawings of the system.
3. A schematic diagram of major components and replacement numbers.

#### 1.06 GENERAL SYSTEM PRODUCT, INSTALLATION AND OVERALL SYSTEM WARRANTY

A. Prior to Owner acceptance, the contractor shall provide to Owner, a product and performance warranty.

B. The warranty shall commence from the date of final written acceptance by the Owner.

C. All conditions for obtaining the warranty shall be the sole responsibility of the contractor.

D. The contractor shall maintain a competent service organization and shall, if requested, submit a service maintenance agreement to the owner after the end of the guarantee period.

#### 1.07 SPECIFIC PRODUCT, INSTALLATION AND OVERALL SYSTEM WARRANTY

A. The entire system shall be warranted free of mechanical or electrical defects for a period of one (1) year after final acceptance of the installation. Any material showing mechanical or electrical defects shall be replaced promptly at no expense to the Owner.

#### 1.08 ACCEPTABLE MANUFACTURERS

A. Manufacturer of general AV systems and associated equipment shall be: QSC and Extron

B. It is the responsibility of the bidder to insure that the proposed product meets or exceeds every standard set forth in these specifications and the equipment's technical data sheets.

C. The functions and features specified are vital to the operation of this facility. Therefore, inclusion of a component's manufacturer in the list of acceptable manufacturers does not release the contractor from strict compliance with the requirements of this specification.

D. All basic electronic equipment (not including cable) specified herein shall be produced by a single manufacturer of established reputation and experience who shall have produced similar



apparatus for at least three or more years and who shall be able to refer to similar installations rendering satisfactory service.

## 2.00 PART 2- PRODUCTS

A. Video Management- Extron DTP Crosspoint 108 4k IPCP Q MA70 with Link License. With all associated HDMI Transmitters and Recievers as required for fully operational system.

1. Control by use of multiple TLP PRO 1025m

B. Audio Management- QSC Q-Sys Platform utiliziong Core 110F Controller.

1. Control by use of mulitiple TSC-101-G3
2. Amplifiers to be QSC Q-Sys CX-Q8K8
3. Speakers to be QSC AP-5122, Q-Sys PL-DC12 and Q-Sys PL-Sub15.
4. Wireless Microphone system- Shure ULDX. Provide 1 Body pack and 3 hand held wireless microphones

C. Assistive Listening- Williams T-55 Transmitter base station with Antennae.

1. Provide Min. of 100 R37N Recievers and Min. 25 Neckloops.
2. Provide all required ADA signage.

D. Projection- Epson Pro L1200U WUXXGA 3LCD Projector with 4K with Lens.

## 2.01 Functions

- A. A Fire alarm relay shall be installed to cause a complete system Mute of all video and audio functions.
- B. Any video input can be routed individually or together to any output.
- C. Any Audio, either audio directly, or from video, may be routed to gym seating speakers, or center cluster speakers as user selection.
- D. Projectors and monitors On/Off, shall be all controlled via the Crosspoint Media Matrix Controller
- E. Any Audio being presented to any speakers, shall be routed also to Assistive Listening system.
- F. Contractor shall hold 3 meetings with Architect, Engineer and Owner Representatives. 1<sup>st</sup> Meeting will before installation starts. Object of meeting to go over owner and contractor general needs. Such as IP address for any network connections, button layout ideas etc.. 2<sup>nd</sup> Meeting will be before final acceptance and before programming. Meeting objective to provide owner with menu choice screen examples and for contractor to verify that Owner requested routing is taken into account. 3<sup>rd</sup> Meeting will be 2 weeks after occupancy if required programming corrections or needs are encountered. All programming to be included in bid. These meetings do not take the place of any training noted below. .

## PART 3 - EXECUTION

### 3.01 GENERAL INSTALLATION REQUIREMENTS

A. The wiring of the system shall be executed in accordance with the drawings and the equipment manufacturer's wiring diagrams. It shall be the responsibility of the factory-authorized distributor of the approved equipment to install the equipment and guarantee the system to operate as per plans and specifications.

B. Furnish all conduit, junction boxes, conductors, equipment plugs, terminal strips, etc., and labor to install a complete and operable system.

C. The cables within racks or cabinets shall be carefully cabled and laced with no. 12 Cord waxed linen lacing twine or ty-raps.

D. Splices of conductors in underground pull boxes are not permitted.

E. The labor employed by the contractor shall be regularly employed in the installation and repair of the specified systems and shall be acceptable to the owner and architect to engage in the installation and service of this system.

F. The contractor shall thoroughly clean all equipment and materials. All exposed parts of the equipment, cabinets, and other equipment shall be left in a clean condition, unblemished and free of all dirt, dust, smudges, spots, fingerprints, etc., The contractor shall remove all debris and rubbish occasioned by the electronic systems work from the site. The contractor shall thoroughly clean all buildings of any dirt, debris, rubbish, marks, etc., Caused by the performance of this work.

G. The system must meet all local and other prevailing codes.

H. All cabling installations shall be performed by qualified technicians.

I. Contractor shall install network drop for panel from existing IDF/MDF for communications, and provide all necessary programming to connect to districts Network and Control software.

J. In order to ensure proper terminations, it is required that all cables shall be stripped using a special tool approved by the manufacturer of the cable / terminating device.

K. The use of lubricants (i.e. Yellow 77) to facilitate the installation of cables in conduits is highly discouraged. If such a lubricant must be used, the contractor shall verify the acceptability of the lubricant to be used with the cable manufacturer, prior to using such a lubricant.

L. Under no circumstance are "channel locks" or other pliers to be used.

M. Cable may be run exposed above ceilings, provided the cabling is supported independent of other utilities such as conduits, pipes, and the ceiling support systems. The cables shall not be laid directly on the ceiling panels. The use of cable ties shall be done in accordance with the cable manufacturer's requirements. The cable jacket composition must meet local and all other prevailing fire and safety codes.



N. All firewalls penetrated by system cabling shall be sealed by use a non-permanent fire blanket or other method in compliance with the current edition of National Fire Protection Association (NFPA) and the National Electric Code (NEC) or other prevailing code. The contractor must not use concrete or other non-removable substance for fire stopping on cable trays, wireways or conduits. Contractors who use this method will be required to replace all cables affected and provide the original specified access to each effected area.

O. Contractor shall connect system to District Network.

P. Materials shall be installed in strict compliance with local building codes. All work shall be performed in accordance with the Extron and QSC instructions and in a manner satisfactory to the owner's representative.

Q. The installer shall be fully qualified and factory trained by Extron and QSC, Inc. in the installation, operation, and programming of the system.

### 3.2 GENERAL TESTING REQUIREMENTS

A. Provide all instruments for testing and demonstrating in the presence of the owner's inspector that the frequency response is as stated in the factory data sheets. Check all circuits and wiring to verify they are free of shorts and grounds.

B. System shall be complete and properly operating prior to calling for the test. The inspector, contractor and engineer shall walk test system at district's option and contractor shall make minor satisfactory adjustments to the system in the presence of the inspector. Contractor shall coordinate the time of test with the district inspector. This test shall be performed during a time when there are no other persons on the site.

C. Provide two portable radio transceivers to be used when walk testing the system. The transceivers shall be capable of communication throughout the entire site.

### 3.03 FINAL ACCEPTANCE

A. The Owner or Owner's representative may visit the site during the installation of the system to ensure that correct installation practices are being followed.

B. The Owner or Owner's representative will conduct a final job review once the contractor has finished the job. This review will take place within one week after the contractor notifies the owner.

C. Two copies of all as-built drawings for all identifications shall be provided to the Owner before the owner's review.

D. The Owner or Owner's representative will review the installation and drawings prior to the system acceptance.

E. The Owner or Owner's representative may test some of the systems features to ensure that the certification data is correct.

F. In the event that repairs or adjustments are necessary, the contractor shall make these repairs at his own expense. All repairs shall be completed within 10 days from the time they are discovered.

G. The contractor shall provide not less than eight (8) hours for site instruction of personnel in the operation and maintenance of the installed systems. This instruction time shall be divided as directed by the Owner.

END OF SECTION